

Program International Seminar

"Personal Networks: Methods and Applications"

Autonomous University of Barcelona, July 6-8, 2011



Organizers

The Personal Networks Laboratory (**egolab**-GRAFO), Department of Social and Cultural Anthropology, UAB.

The Sociological Research Centre on Everyday Life and Work (**QUIT**), Department of Sociology, UAB.

Contact persons:

José Luis Molina, office B9-229, Dept of Social and Cultural Anthropology, phone +34 93 581 11 42, joseluis.molina@uab.es

Miranda Lubbers, office B9-225, Dept of Social and Cultural Anthropology, phone +34 93 581 12 39, mirandajessica.lubbers@uab.es

Program

Wednesday July 6th, 2011

(Place: Faculty of Political Sciences and Sociology (UAB), indicated as "Facultat de CCPP i de Sociologia". See the map at the end of this document)

16.00 - 18.00	Keynote address "Personal networks and whole networks: A discussion" Steve Borgatti
---------------	--

Thursday July 7th, 2011

(The VISIONE workshop will take place in the Computer Lab "B5B/-131 Aula 33", Faculty of Arts and Faculty of Psychology, "Facultat de Filosofia y Lletres - Facultat de Psicologia"; the rest of the seminar will take place in the same building in the "Sala de Graus" of the "Facultat de Filosofia y Lletres". See the map at the end of this document)

09.30	Workshop "Visualisation of social networks with VISIONE" <u>Jürgen Lerner</u>
11.00	Coffee & tea (Just outside the "Sala de Graus")
11.30	Opening
11.30	<u>José Luis Molina</u> Welcome
11.45	<u>Miranda Lubbers</u> The Observatory of Personal Networks (OPEN)
12.00	Session 1 "The personal networks of young adults"
12.00	<u>Susanna Zaccarin & Giulia Rivellini</u> Instrumental and social networks in well-being of Italian young adults
12.30	<u>Jodi Ford & Christopher Browning</u> Longitudinal effects of racial segregation on racially assortative mixing in personal sexual networks during the transition from Adolescence to young adulthood
13.00	<u>Filip Agneessens & Rik van de Kerckhove</u> Social support multiplexity and stress among young adults: Gender differences in the impact of support from partner, family and friends?
13.30	Lunch
15.30	Session 2 "Miscellaneous"
15.30	<u>Mario Small & Anna Counts</u> Whom We Talk to When We Talk about Important Matters: Institutional Conditions, Weak Ties, and Discussion Partners
16.00	<u>Shira Offer</u> Processes of Exclusion and Withdrawal from Personal Networks among Low-Income Families: the Principle of Reciprocity Reconsidered
16.30	Coffee & tea
17.00	Session 3 "Methods and measures"
17.00	<u>Jürgen Lerner</u> Visualization of network ensembles
17.30	<u>Irene Cruz</u> Measures of tie strength: A review
18.00	<u>Christopher Browning & Jodi Ford</u> Collecting Space-Time Situated Personal Network Data Using Name and Location Generators
18.30	<u>Carlos Lozares, José Luis Molina, Alejandro Garcia Macias, & Octavio Maza</u> The measurement of social capital using the position generator in local contexts
- 19.00	with an atypical occupational configuration

The names of the presenting authors are underlined

Friday July 8th, 2011

(Place: Room P-38, Faculty of Psychology, "Facultat de Psicologia". See the map at the end of this document)

09.00	Session 4 "The CASREDIN project: Personal networks in Catalunya"
09.00	<u>Carlos Lozares & Joan Miquel Verd</u> Analytical possibilities of personal networks as applied within a research project
09.30	<u>José Luis Molina, Carlos Lozares & Miranda Lubbers</u> The geographical distribution of the personal networks of residents of Catalonia.
10.00	Coffee & tea
10.15	Session 5 "The personal networks of immigrants"
10.15	<u>Mireia Bolibar</u> Looking at migrant social integration from the social network perspective
10.45	<u>Ashton Verdery, Ted Mouw, Sergio Chavez, Heather Edelblute</u> The structure of migrant networks: New data and theory
11.15	<u>Verónica de Miguel Luken, & Mark Tranmer</u> Personal support networks of immigrants to Spain: A multilevel analysis
11.45	<u>Miranda Lubbers & José Luis Molina</u> The process of social integration among immigrants: A longitudinal personal network perspective
12.15	Coffee & tea
12.30	Session 6 "Miscellaneous"
12.30	<u>Evgenia Dolgova</u> Birds of the feather 2.0: Is there a personality-based homophily?
13.00	<u>Oskar Casquero & Javier Portillo</u> A study of the personal learning networks in a distributed and heterogeneous online course supported by an iPLE
13.30	<u>Christian Pescher</u> A multi-stage decision model of consumers' forwarding behavior in viral marketing campaigns
14.00	Lunch
-	
15.30	

The names of the presenting authors are underlined

List of presenters

Agneessens, Filip - Dept of Sociology & ICS, University of Groningen, The Netherlands

Bolibar, Mireia - Dept of Sociology, Autonomous University of Barcelona, Spain

Borgatti, Steve - Dept of Management & LINKS Center, University of Kentucky, USA

Browning, Christopher - Dept of Sociology, Ohio State University, USA

Casquero, Oskar - Dept of Systems Engineering and Automatics University of the Basque Country, Spain

Cruz, Irene - Dept of Sociology, Autonomous University of Barcelona, Spain

Dolgova, Evgenia - Dept of Strategic Management and Entrepreneurship, Erasmus University Rotterdam, The Netherlands

Ford, Jodi - College of Nursing, Ohio State University, USA

Garcia Macias, Alejandro - Dept of Communication, Autonomous University of Aguascalientes, Mexico

Lerner, Jürgen - Dept of Computer & Information Science, University of Konstanz, Germany

Lozares, Carlos - Dept of Sociology, Autonomous University of Barcelona, Spain

Lubbers, Miranda - Personal Networks Laboratory, Dept of Social and Cultural Anthropology, Autonomous University of Barcelona, Spain

Molina, José Luis - Personal Networks Laboratory, Dept of Social and Cultural Anthropology, Autonomous University of Barcelona, Spain

Offer, Shira - Dept of Sociology and Anthropology, Bar Ilan University, Israel

Pescher, Christian - Munich School of Management, Ludwig-Maximilians University München, Germany

Rivellini, Giulia - Dept of Statistical Sciences, Catholic University "Sacro Cuore", Milan, Italy

Small, Mario - Dept of Sociology, University of Chicago, USA

Tranmer, Mark - CCSR & Mitchell Centre for Social Network Analysis, University of Manchester, UK

Verd, Joan Miquel - Dept of Sociology, Autonomous University of Barcelona, Spain

Verdery, Ashton - Dept of Sociology University of North Carolina, Chapel Hill, USA

Zaccarin, Susanna - Dept of Economics, Business, Mathematics and Statistics B. de Finetti, University of Trieste, Italy

Map of the Bellaterra Campus of the Autonomous University of Barcelona

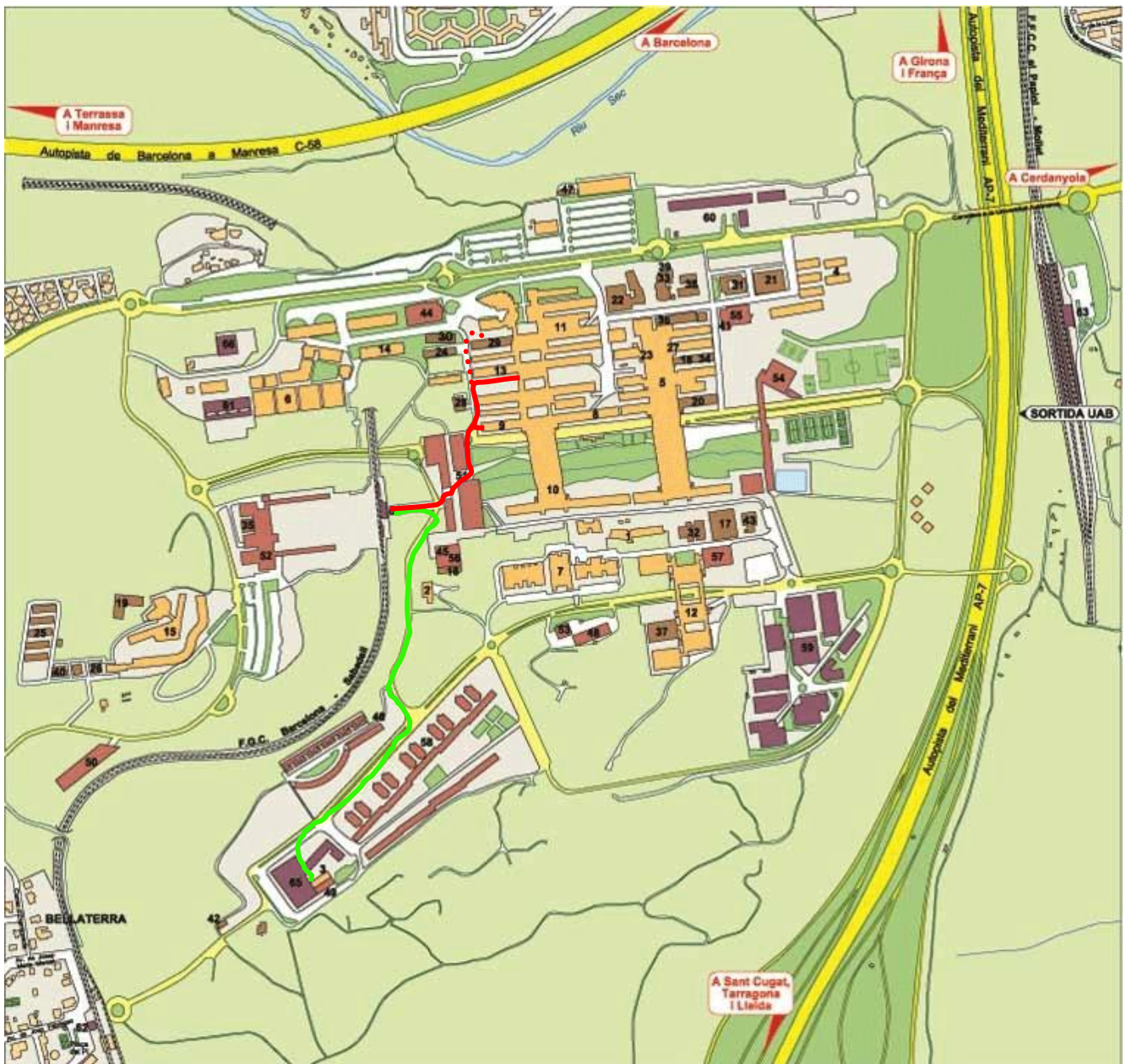

The **red route** takes you from the train station to the Faculty of Political Sciences and Sociology (9 on the map, you may need to increase the size of the image; Keynote address), Faculty of Psychology (13; Workshop and Seminar on Friday), and the Faculty of Arts (Seminar on Thursday).

- To get to the faculties, just follow the crowd to exit the train station until you arrive on a square with some shops, the "Plaça Civica". Cross the square diagonally to your left, take the wooden ramp and continue your walk up hill. On your right hand you will find the faculties of Sociology, Psychology and Arts (and if you continue along the dotted red line, the bar/restaurant). The map on the next page shows you the Psychology and Arts building.

The **green route** takes you from the train station to the Campus Hotel Serhs (65). It is about a ten minutes walk.

Please find the **interactive map of the campus** at <http://www.uab.es/mapes/>

Map of the Faculties of Arts (upper part) and Psychology (lower part)

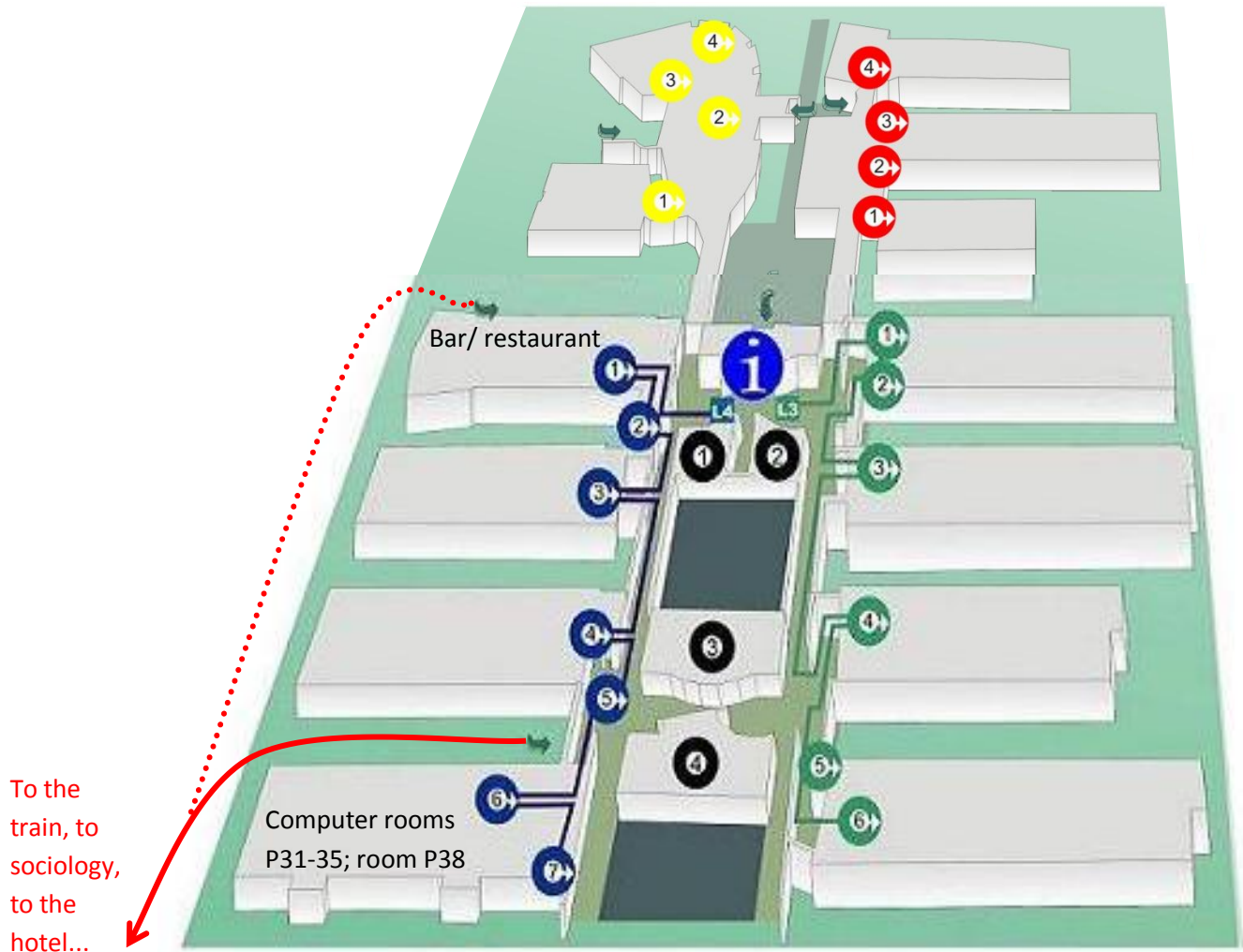

Workshop: Computer room P33 (Blue point 7)

Seminar on Thursday: "Sala de Graus" (Black point 2)

Seminar on Friday: Room P38 (Blue point 7)

Bar and restaurant and outdoor terrace: (Blue point 1)

Offices of José Luis Molina and Miranda Lubbers (Yellow point 1, take the stairs or the elevator to the second floor; José Luis' office is B9-229, Miranda's B9-225).

The **green arrows** show the entrance points to the building. You can find the main entrance right above the information point. However, if you come from the train station, you will most likely enter the building using a side door between the blue points 5 and 6 (the green arrow connected to the red line in the picture above).

Wifi

The building that is shared by the Faculty of Arts and the Faculty of Psychology has wifi coverage, but the quality of the signal varies. You should be able to connect to the internet without problems in the Sala de Graus. To connect, write the name of the UAB homepage in your browser (**www.uab.cat**). You will then receive an access page on which you will have to choose the type of access (guest or personalized). Identify as a guest and click on OK. You can find coverage maps on the site <http://www.uab.es/servlet/Satellite/des-del-campus/connexio-sense-fils/planols-de-cobertura-1096479276054.html> (it is in Catalan, but you only need to choose the faculty where you are).